

3110071

**MECHANICAL SHAFT SEAL FOR PUMP 2250**

Date: 06-08-2025



Technical data

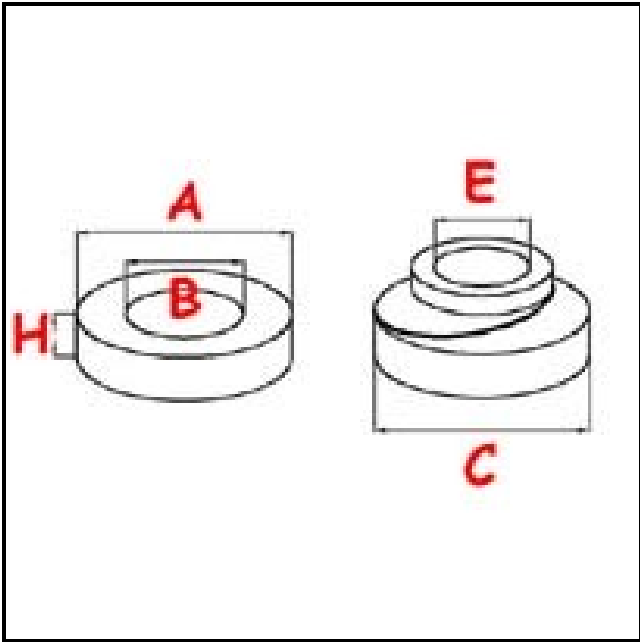

BAKED CLAY SEAL HEIGHT mm	H=8mm
BAKED CLAY SEAL INTERNAL DIAMETER mm	B=21mm
BAKED CLAY SEAL EXTERNAL DIAMETER mm	A=42mm
MECHANIC SEAL EXTERNAL DIAMETER mm	C=39mm
MECHANIC SEAL INTERNAL DIAMETER mm	E=17mm

Manufacturer code

ELETTROBAR EUROTEC SRL