

1103907

FAN MOTOR 0,12KW 230V 50/60Hz

Date: 04-05-2025



Technical data

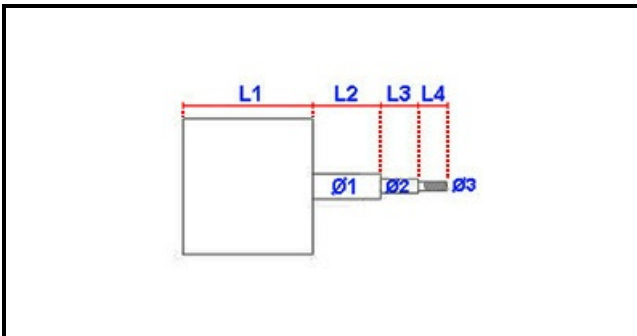

KILOWATT KW	KW=0,12
MONOPHASE	230V
CAPACITOR	6,3mf

Manufacturer code

NIDEC FIR INTERNATIONAL SRL
TECNOEKA SRL
NIDEC FIR INTERNATIONAL SRL
NIDEC FIR INTERNATIONAL SRL